



#### About Bartelt Packaging

Bartelt is a trusted manufacturer of pouching, cartoning, shrink wrapping, over wrapping, and case and tray packing systems, providing dependable and long-lasting solutions to food and non-food industries. Bartelt also operates as the master distributor for both FLtècnics' rollstock and pre-made pouch and Cetec Industrie large bag format packaging machines. As the world's first developer of intermittent motion horizontal form fill seal pouching machines, Bartelt is a true pioneer in automated packaging. From simple to advanced applications spanning primary and secondary packaging, quality components and a durable design are incorporated into every solution. Bartelt is a product brand of ProMach, a global leader in packaging line solutions. As part of the ProMach Flexibles & Trays business line, Bartelt helps our packaging customers protect their products and earn the trust of their consumers. ProMach is performance, and the proof is in every package. Learn more about Bartelt at [www.BarteltPackaging.com](http://www.BarteltPackaging.com) and more about ProMach at [www.ProMachBuilt.com](http://www.ProMachBuilt.com)

BARTELT PACKAGING, LLC  
5501 N. Washington Blvd.  
Sarasota, FL 34243

P: 941-359-4000  
E: [Bartelt.Sales@ProMachBuilt.com](mailto:Bartelt.Sales@ProMachBuilt.com)  
[BarteltPackaging.com](http://BarteltPackaging.com)



## IMC CARTONER

### INTERMITTENT MOTION END-LOAD

F&T

FLEXIBLES  
& TRAYS

# IMC Cartoner

## INTERMITTENT MOTION END-LOAD

### Bartelt IMC Cartoner

The Bartelt® IMC Cartoner is an intermittent motion, servo-driven, horizontal end-load solution for multipack, single pack, tuck or glue applications and complex product configurations. Operation is on-demand, and all major functions can be independently optimized via the operator interface.

Depending on product and configurations, the IMC can achieve output up to 120 cartons per minute.

#### PRODUCT APPLICATIONS

- Baked Goods
- Confectionery
- Frozen Foods
- Food Products
- Pharmaceuticals
- Consumer Goods
- Personal Care
- Tobacco Goods



#### FEATURES & BENEFITS

- No product/no carton, no carton/no load feature
- Air operated top rail
- Modular design
- Full servo execution
- Quick and repeatable size changeover
- Single-packs and multi-packs
- Runs a variety of carton sizes and styles
- Easy to upgrade
- Ergonomically designed

#### OPTIONS

- Carton coding – inkjet, laser, thermal transfer
- Open flap detect
- Product conditioner
- Various product transfers
- Servo adjustable in-feed
- Drop gate combiner
- Checkweigher
- Glue system

#### CONFIGURATION

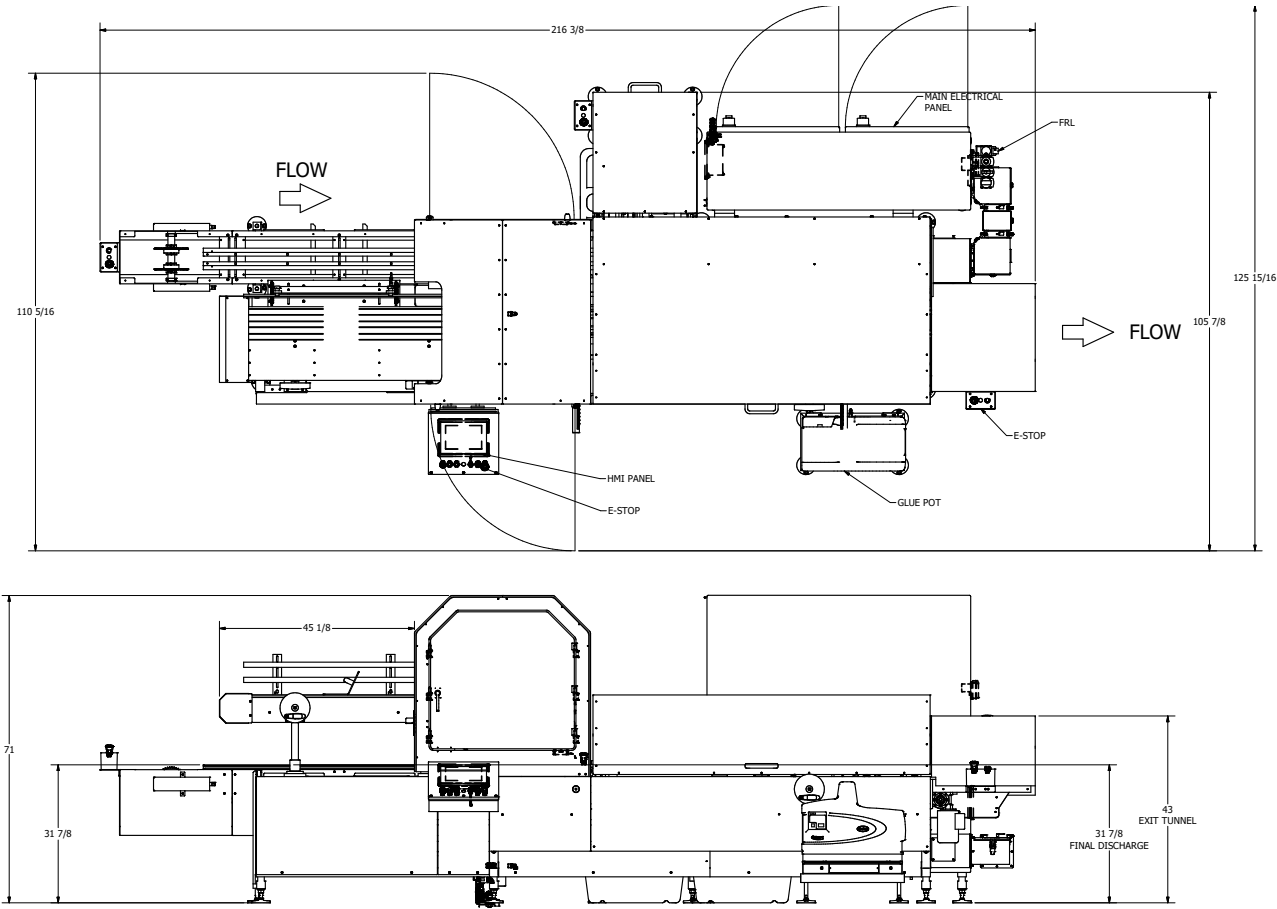

Contact Bartelt to inquire about packaging machinery to fit your unique requirements.  
(941) 359-4000

#### MACHINE SPECIFICATIONS

Power	460V, 60 Hz, 3-phase or 400V, Controls: 24VDC	Drive Motor	Servo main drive
Control	Standard—Rockwell electronic design	Air Flow	20 SCFM / 0.57 SCMM
Output	Up to 120 cpm	Air Pressure	80 PSI / 5.5 Bar

#### CARTON DIMENSIONS

Length	Min: 2.5" (64mm) / Max: 13.5" (342 mm)	Depth	Min: 3.25" (83 mm) / Max: 12" ( 304 mm)
Width	Min: 0.63" (16 mm) / Max: 6" (153 mm)		

#### CARTON STYLES

Standard Tuck End	Sleeve
Standard Glue Flap	Fifth Panel
Reverse Tuck End	Gable Top